



Bendigo

AVIVA[®]
COMMUNITIES

Hillcrest

*Watch the world go by
from your expansive verandah*



Talk to us on 1800 387 637
or visit www.avivacommunities.com.au

Photographs and illustrations are intended to be a visual aid only and may not accurately represent the actual home due to design evolution. Drawings not to scale and subject to change without notice. All details are correct at time of publication. Please refer to working drawings for final dimensions and construction detail.

Your path, re-imagined



Bendigo

Hillcrest

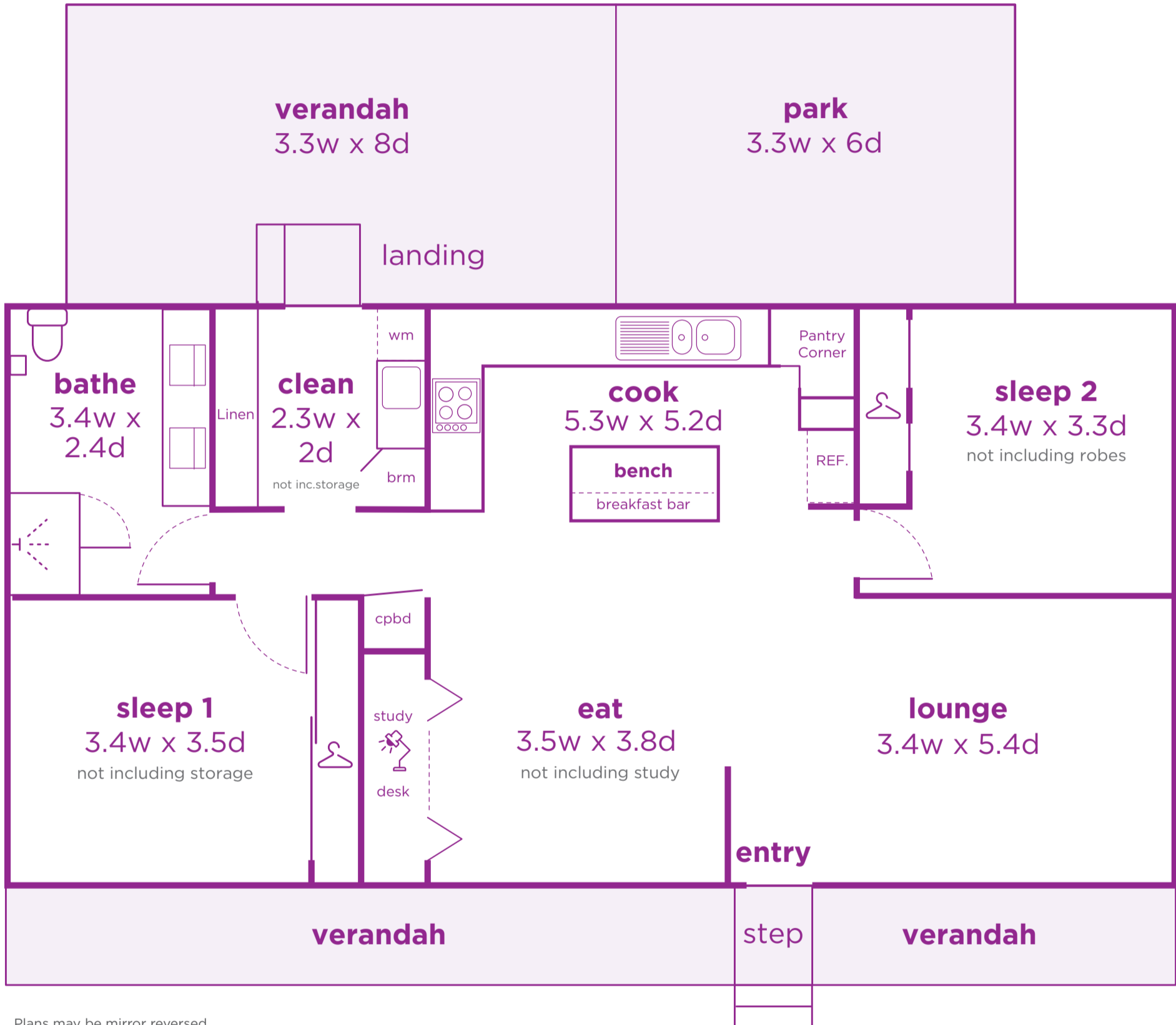

Plans may be mirror reversed.

Measurements shown are in m²

living 104.40 m²
carport/verandah 45.87 m²
porch 17.40 m²
TOTAL 167.67 m²

Hillcrest inclusions:

- Master bedroom suite with spacious robes
- Generous secondary bedroom with built in storage
- Study nook
- Wall, floor & ceiling insulation
- Reverse cycle split system heating & cooling plus gas ducted heating
- Stainless steel oven, cooktop, dishwasher, microwave & rangehood
- Choice of carpet, tiles or floorboards
- Light fittings
- Window furnishings throughout
- Separate laundry
- Landscaping with garden shed
- Single carport
- Letterbox at Clubhouse
- Clothesline
- Plenty of storage